

PUBLIC COMMENT

4/19/2021

**Ann-Marie Aubrey**

---

**From:** Anthony Simpson <antsim14@gmail.com>  
**Sent:** Monday, April 19, 2021 1:28 PM  
**To:** Ann-Marie Aubrey; Gieseke, Roger {FLNA}; Sil.Quenga@pepsico.com  
**Subject:** Re: Property Access

To be clear, I am happy with the corrections and have no objection with Frito-Lay moving forward with the Yellin Lot plans.

Anthony Simpson

On Mon, Apr 19, 2021 at 10:35 AM Anthony Simpson <[antsim14@gmail.com](mailto:antsim14@gmail.com)> wrote:  
April 15, 2021

Dear, Ann Marie Aubrey  
Town of Killingly Planning and Zoning Department

Frito-Lay Inc has modified their map showing my access across the Yellin lot.  
After My Discussion with Roger Gieseke and Sil Quenga My access will remain the same. They have assured me there is no Activity planned on the 25 foot Right of Way. Attached is the Map showing where they removed trailers and indicated, no parking in the North West corner of the Lot.

Sincerely, Anthony Simpson  
75 Soap street, Dayville

## **Ann-Marie Aubrey**

---

**From:** Anthony Simpson <antsim14@gmail.com>  
**Sent:** Monday, April 19, 2021 10:35 AM  
**To:** Ann-Marie Aubrey; Gieseke, Roger {FLNA}; Sil.Quenga@pepsico.com  
**Subject:** Property Access  
**Attachments:** PLANNING AND ZONING YELLIN EXHIBIT-Layout1 (1).pdf

April 15, 2021

Dear, Ann Marie Aubrey  
Town of Killingly Planning and Zoning Department

Frito-Lay Inc has modified their map showing my access across the Yellin lot.  
After My Discussion with Roger Gieseke and Sil Quenga My access will remain the same. They have assured me there is no Activity planned on the 25 foot Right of Way. Attached is the Map showing where they removed trailers and indicated, no parking in the North West corner of the Lot.

Sincerely, Anthony Simpson  
75 Soap street, Dayville

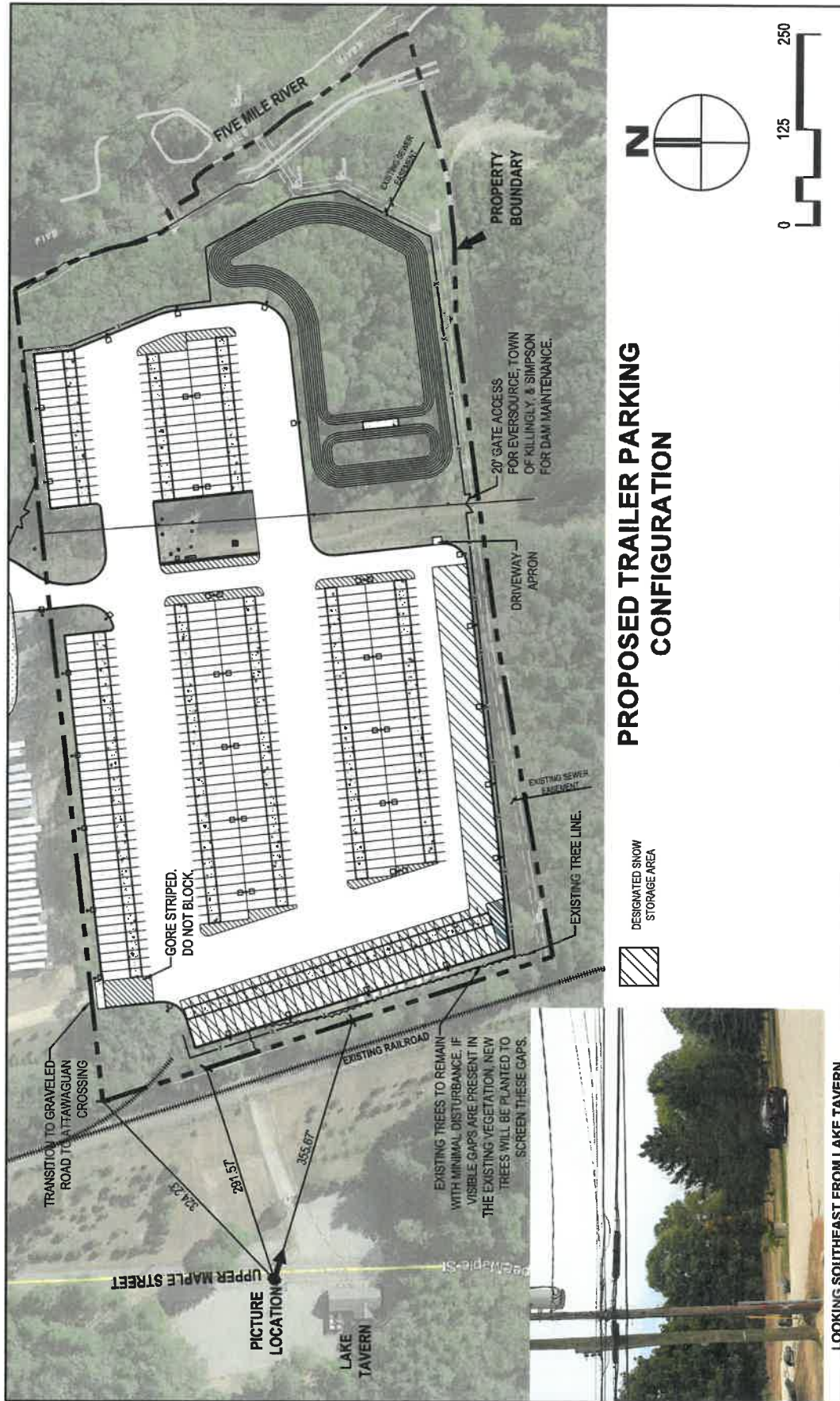

## PROPOSED TRAILER PARKING CONFIGURATION

## YELLIN LOT AERIAL SITE PLAN

**YELLIN TRAILER  
PARKING LOT**  
APRIL 08, 2021



111 Riverside Avenue  
Jacksonville, Florida 32202  
Phone # (904) 791-4500

LOOKING SOUTHEAST FROM LAKE TAVERN

