

TOWN OF KILLINGLY

PLANS

FOR IMPROVEMENTS TO

OWEN BELL PARK POND

PREPARED BY
ENGINEERING DEPARTMENT

MARCH, 2023

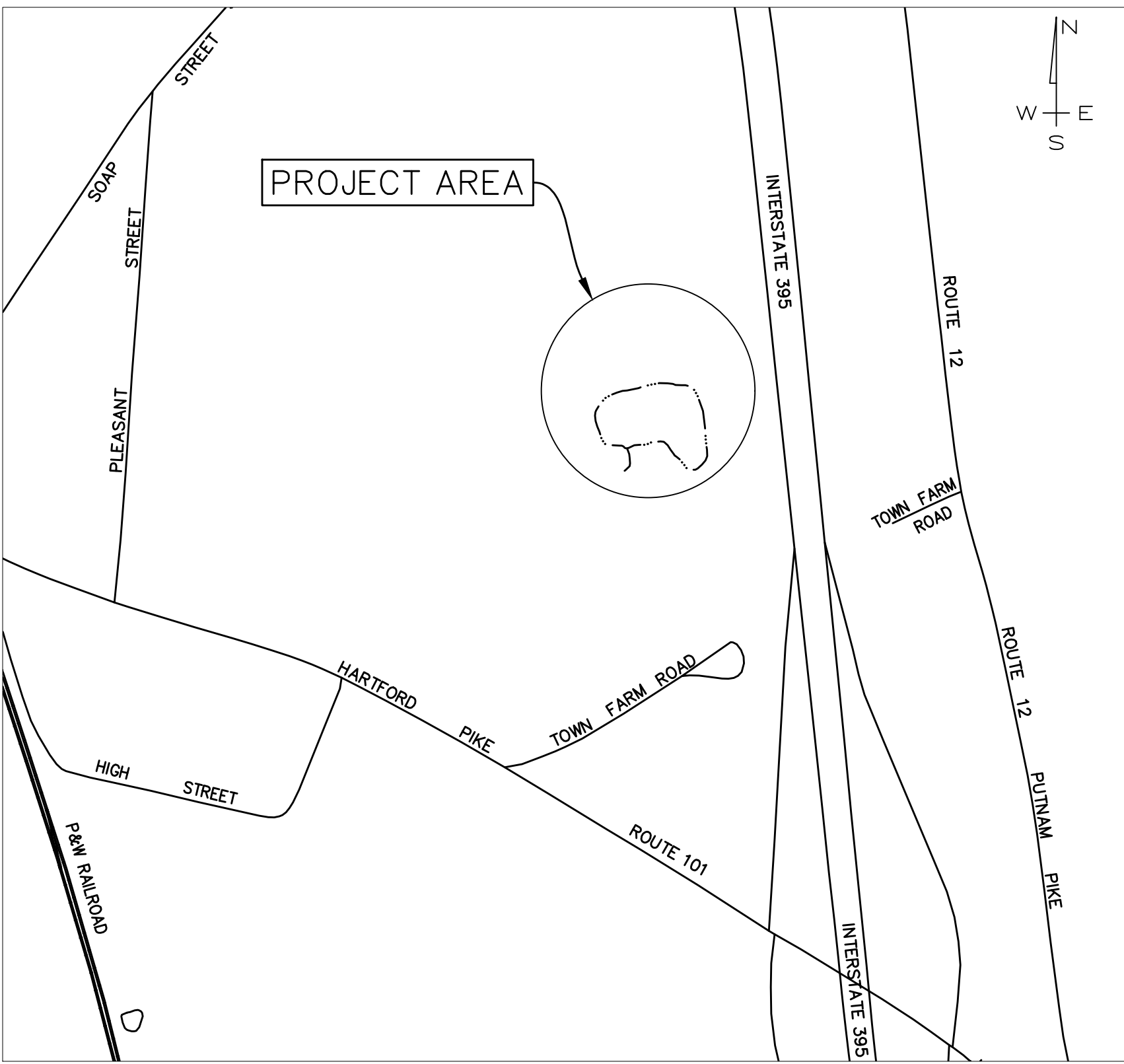

LOCATION PLAN

NOT TO SCALE

INDEX TO DRAWINGS

1. TITLE SHEET
2. DREDGING PLAN
3. DEWATERING PLAN
4. DETAILS & NOTES

REVISIONS

1. 3/2/2023 – POND SIDE SLOPE BENCHING

Account Number:	666435
Customer Name:	Killingly, Town Of
Customer Address:	Killingly Town Of 172 Main ST Finance Office Killingly CT 06239-2822
Contact Name:	Ann-Marie Aubrey
Contact Phone:	
Contact Email:	
PO Number:	

Date:	03/08/2024
Order Number:	9942372
Prepayment Amount:	\$ 0.00

Column Count:	1.0000
Line Count:	82.0000
Height in Inches:	0.0000

Print

Product	#Insertions	Start - End	Category
NEO NRW The Bulletin	1	03/12/2024 - 03/12/2024	Govt Bids & Proposals
NEO wickedlocal.com	1	03/12/2024 - 03/12/2024	Govt Bids & Proposals

As an incentive for customers, we provide a discount off the total order cost equal to the 3.99% service fee if you pay with Cash/Check/ACH. Pay by Cash/Check/ACH and save!

Total Cash Order Confirmation Amount Due	\$435.66
Tax Amount	\$0.00
Service Fee 3.99%	\$17.38
Cash/Check/ACH Discount	-\$17.38
Payment Amount by Cash/Check/ACH	\$435.66
Payment Amount by Credit Card	\$453.04

Order Confirmation Amount	\$435.66
----------------------------------	-----------------

Ad Preview

**REQUEST for PROPOSAL
TOWN OF KILLINGLY,
CONNECTICUT
For
DREDGING OWEN BELL
PARK**

Sealed bids for the Dredging of the pond at Owen Bell Park will be received at the Office of the Town Engineer, 172 Main Street, Killingly, CT 06239 until 2:00 PM Thursday April 11, 2024 EST, at which time they will be publicly opened and read aloud in the Town meeting room located on the second floor of the Killingly Town Hall, 172 Main Street, Killingly CT 06239.

Please note there is a site walk on March 19, 2024 at 10:00 AM. All bidders must meet in the main parking lot for 580 Hartford Pike, Killingly CT 06239.

All bids must be submitted in a sealed envelope bearing the bidder's name and the bid name.

The bid documents may be examined at the Office of the Killingly Town Engineer, 172 Main Street, Killingly, CT.

Bid documents are available digitally only and can be found on the Town of Killingly website: <https://www.killingly.org/fina> nce/pages/bids-and-rfos or the CTSource website <https://portal.ct.gov/DAS/CTS> ource/ctsource. Neither the Owner nor the Engineer will be responsible for full or partial sets of Bid Documents obtained from any other source.

The Town of Killingly reserves the right to accept or reject any or all bids, in part or in whole, and to waive any informality if it is deemed to be in the best interest of the Town to do so.

No bidder may withdraw their bid within 60 days after the actual date of bid opening. Should there be a reason why the contract cannot be awarded within the specified period, this time may be extended by mutual agreement between the Town and the designated, qualified low bidder.

The Town is an affirmative action, equal opportunity employer.

TOWN of KILLINGLY

#9942372
Norwich Bulletin 3/12/24

GENERAL NOTES:

1. THE HORIZONTAL DATUM SHOWN HEREON IS THE NORTH AMERICAN DATUM OF 1983 (NAD 83) CONNECTICUT STATE PLANE COORDINATE SYSTEM, FEET.
2. THE VERTICAL DATUM FOR TOPOGRAPHY SURROUNDING THE POND AND BATHYMETRY IN THE POND REFERENCES NAVD88.
3. POND BOTTOM CONTOURS ARE IN FEET, AND WERE GENERATED USING AUTOCAD CIVIL 3D. DATA TO CREATE CONTOURS FROM WATER DEPTH MEASUREMENTS IN THE FIELD BY THE TOWN OF KILLINGLY STAFF IN JULY 2021 AND CAN ONLY BE CONSIDERED TO REPRESENT CONDITIONS EXISTING AT THAT TIME. THE WATER SURFACE ELEVATION AT THE TIME OF FIELD MEASUREMENTS WAS 95.50 FEET AND ALL WATER DEPTHS ARE REFERENCED TO THIS ELEVATION.
4. PROPOSED DREDGE AND EXCAVATION CONTOURS SHOWN ARE APPROXIMATE. PROJECT OBJECTIVE IS TO DREDGE AND EXCAVATE ACCUMULATED SOFT SEDIMENT WITHIN THE PROJECT LIMITS AND CREATE A BASIN WITH A MAXIMUM DEPTH OF 13 FEET BELOW WATER SURFACE, CONTOURS SHOWN RESULT IN A DREDGE VOLUME OF APPROXIMATELY
5. SEDIMENT DEWATERING TO OCCUR ON ADJACENT SOCCER FIELD TO THE NORTH AS SHOWN ON PLANS.

SEDIMENTATION & EROSION CONTROL NOTES:

1. THE CONTRACTOR SHALL PROVIDE EROSION CONTROL MEASURES, AS SPECIFIED ON THE DRAWINGS AS NECESSARY, AND IS REQUIRED BY THE PERMITS.
2. PERIMETER SOIL, AND EROSION CONTROLS SHALL BE PLACED PRIOR TO ANY CONSTRUCTION ACTIVITIES, CONTRACTOR TO NOTIFY THE ENGINEER AT LEAST 38 HOURS PRIOR TO ANY CONSTRUCTION ACTIVITIES. ALL SOIL AND EROSION CONTROLS SHALL BE CHECKED AND REPAIRED AS NECESSARY BY THE CONTRACTOR.
3. ALL STOCKPILE AREAS SHALL BE SURROUNDED BY EROSION CONTROL BARRIERS UNTIL SUCH TIME AS THE MATERIAL IS RESPREAD AND STABILIZED OR TRANSPORTED OFFSITE.
4. TEMPORARY STOCKPILES OF DREDGED/EXCAVATED MATERIAL SHALL BE LOCATED ON-SITE. WITHIN THE DESIGNATED AREAS, ANY MATERIAL NOT RE-USED ON-SITE SHALL BE TRUCKED TO AN ACCEPTABLE OFF-SITE DISPOSAL LOCATION IN ACCORDANCE WITH THE PROJECTS PERMITS.
5. EROSION CONTROL MEASURES SHALL BE INSPECTED DAILY AND DURING AND AFTER EVERY RAIN EVENT, ANY NECESSARY REPLACEMENT OR REPAIR SHALL BE PERFORMED PROMPTLY BY THE CONTRACTOR.
6. DUST SHALL BE CONTROLLED IN ACCORDANCE WITH THE SPECIFICATIONS AND APPLICABLE REGULATIONS.
7. THE CONTRACTOR SHALL PHASE DREDGING OPERATIONS TO MINIMIZE THE AREA DISTURBED OR OPEN TO THE ELEMENTS AT ANY GIVEN TIME.
8. THE SITE SHALL BE LEFT AT A STABLE CONDITION AT THE CLOSE OF EACH DAY.

CONSTRUCTION NOTES:

1. THE CONTRACTOR SHALL CALL "DIG SAFE" AT 1-800-344-7223 AT LEAST 72 HOURS PRIOR TO ANY EXCAVATION.
2. THE CONTRACTOR SHALL, UNDER THE DIRECTION OF THE ENGINEER, ESTABLISH "CONSTRUCTION LIMITS" ON THE SITE BY ACCEPTABLE VISIBLE MARKERS. ALL WORK AND EQUIPMENT SHALL BE CONFINED TO WITHIN THESE LIMITS, UNLESS OTHERWISE SPECIFICALLY AUTHORIZED.
3. NO CHANGES ARE TO BE MADE UNLESS AUTHORIZED BY THE ENGINEER & OR THE TOWN OF KILLINGLY.
4. THE CONTRACTOR SHALL COMPLY WITH ALL APPLICABLE FEDERAL, STATE AND LOCAL SAFETY CODES, REGULATIONS, LEGAL REQUIREMENTS, PERMIT CONDITIONS, ETC.
5. ALL SURFACES DISTURBED BY THIS WORK SHALL BE RESTORED TO THEIR ORIGINAL CONDITION AS DETAILED OR SPECIFIED BY THE ENGINEER.
6. DREDGING SEQUENCE SHALL BE COORDINATED TO MINIMIZE DISTURBANCE OF EXISTING CONDITIONS AND OPERATIONS.
7. DREDGING SHALL TAKE PLACE WITHIN APPROVED WORK WINDOWS.
8. ALL EXISTING PIPING AND STRUCTURES EXPOSED DURING EXCAVATION SHALL BE ADEQUATELY SUPPORTED, BRACED, OR OTHERWISE PROTECTED DURING DREDGING ACTIVITIES.
9. WORK SHALL COMPLY WITH APPLICABLE MUNICIPAL, STATE, AND FEDERAL PERMITS AND REQUIREMENTS.
10. THE CONTRACTOR SHALL OBTAIN AND COMPLY WITH ALL AUTHORIZATIONS NECESSARY FOR CONSTRUCTION AND DREDGED MATERIAL TRANSPORT VEHICLE ENTRY/EXIT/TRAVEL ON STATE AND LOCAL ROADS.
11. NO DREDGED MATERIAL CONTAINING FREE DRAINING LIQUIDS (AS DETERMINED BY THE EPA PAINT FILTER TEST) SHALL BE TRANSPORTED OVER STATE OR LOCAL ROADS.

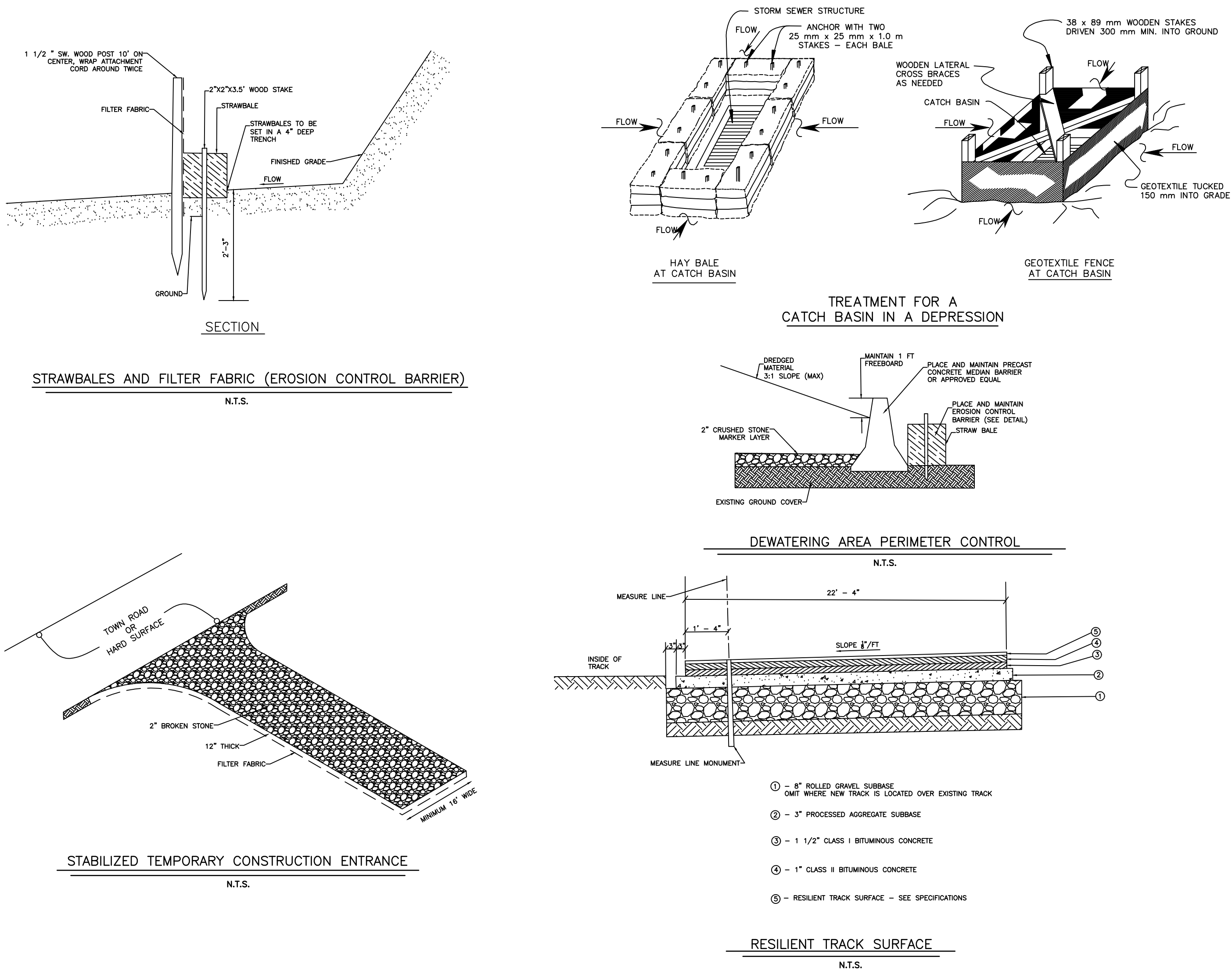

CLARENCE WELTI ASSOC., INC.					CLIENT		PROJECT NAME			
P.O. BOX 397 GLASTONBURY, CONN 06033					TOWN OF KILLINGLY		PROPOSED EXPANSION OF POND AT OWEN BELL PARK			
					550 HARTFORD PKE., KILLINGLY, CT		LOCATION			
TYPE	AUGER	CASING	SAMPLER	CORE BAR.	OFFSET		SURFACE ELEV.	HOLE NO.	MW-1	
SIZE I.D.	3.75"		1.375"		LINE & STA.		GROUND WATER OBSERVATIONS	START DATE	4/14/21	
HAMMER WT.			140lbs		N. COORDINATE		AT 5.0 FT. AFTER 0 HOURS	FINISH DATE	4/14/21	
HAMMER FALL			30"		E. COORDINATE		AT FT. AFTER HOURS			
DEPTH	SAMPLE			A	STRATUM DESCRIPTION + REMARKS					ELEV.
0	1	3-4-8-9	0.0'-2.0'		TOPSOIL					1.0
	2	4-4-2-3	2.0'-4.0'		LIGHT BR FINE SAND AND SILT					2.0
	3	2-2-2-5	4.0'-6.0'		LIGHT GREY/BR SILT, SOME FINE SAND					
5	4	8-8-9-12	6.0'-8.0'							
10	5	6-20-28	10.0'-11.5'		GREY/BR FINE-MED SAND, SOME SILT, LITTLE GRAVEL					10.5
					DARK GREY/BR FINE-CRS SAND, LITTLE GRAVEL, TRACE SILT, FEW COBBLES					13.0
15	6	20-28-20	15.0'-16.5'		GREY/BR FINE-CRS SAND, SOME SILT, LITTLE GRAVEL					18.0
20	7	13-20-25	20.0'-21.5'							
25	8	27-23-17	25.0'-26.5'		BOTTOM OF BORING @ 26.5'					26.5
					2" DIA WELL @ 25.0'					
					10.0' SCREEN					
					14.5' RISER					
					SAND FROM 26.5' TO 20.0'					
					BACKFILLED FROM 20.0' TO 14.0'					
35										
LEGEND: COL. A:							DRILLER: T. CZMYR			
SAMPLE TYPE: D=DRY A=AUGER C=CORE U=UNDISTURBED PISTON S=SPLIT SPOON							INSPECTOR:			
PROPORTIONS USED: TRACE=0-10% LITTLE=10-20% SOME=20-35% AND=35-50%							SHEET 1 OF 2 HOLE NO. MW-1			

CLARENCE WELTI ASSOC., INC.					CLIENT		PROJECT NAME			
P.O. BOX 397 GLASTONBURY, CONN 06033					TOWN OF KILLINGLY		PROPOSED EXPANSION OF POND AT OWEN BELL PARK			
					550 HARTFORD PKE., KILLINGLY, CT		LOCATION			
DEPTH	SAMPLE			A	STRATUM DESCRIPTION + REMARKS					ELEV.
	NO.	BLOWS/6"	DEPTH							
					BENTONITE SEAL FROM 14.0' TO 12.0'					
					BACKFILLED FROM 12.0' TO SURFACE					
40										
45										
50										
55										
60										
65										
70										
75										
LEGEND: COL. A:							DRILLER: T. CZMYR			
SAMPLE TYPE: D=DRY A=AUGER C=CORE U=UNDISTURBED PISTON S=SPLIT SPOON							INSPECTOR:			
PROPORTIONS USED: TRACE=0-10% LITTLE=10-20% SOME=20-35% AND=35-50%							SHEET 2 OF 2 HOLE NO. MW-1			

CLARENCE WELTI ASSOC., INC.					CLIENT		PROJECT NAME			
P.O. BOX 397 GLASTONBURY, CONN 06033					TOWN OF KILLINGLY		PROPOSED EXPANSION OF POND AT OWEN BELL PARK			
					550 HARTFORD PKE., KILLINGLY, CT		LOCATION			
TYPE	AUGER	CASING	SAMPLER	CORE BAR.	OFFSET		SURFACE ELEV.	HOLE NO.	MW-1	
SIZE I.D.	3.75"		1.375"		LINE & STA.		GROUND WATER OBSERVATIONS	START DATE	4/14/21	
HAMMER WT.			140lbs		N. COORDINATE		AT 5.0 FT. AFTER 0 HOURS	FINISH DATE	4/14/21	
HAMMER FALL			30"		E. COORDINATE		AT FT. AFTER HOURS			
DEPTH	SAMPLE			A	STRATUM DESCRIPTION + REMARKS					ELEV.
0	1	3-4-8-9	0.0'-2.0'		TOPSOIL					1.0
	2	4-4-2-3	2.0'-4.0'		LIGHT BR FINE SAND AND SILT					2.0
	3	2-2-2-5	4.0'-6.0'		LIGHT GREY/BR SILT, SOME FINE SAND					
5	4	8-8-9-12	6.0'-8.0'							
10	5	6-20-28	10.0'-11.5'		GREY/BR FINE-MED SAND, SOME SILT, LITTLE GRAVEL					10.5
					DARK GREY/BR FINE-CRS SAND, LITTLE GRAVEL, TRACE SILT, FEW COBBLES					13.0
15	6	20-28-20	15.0'-16.5'		GREY/BR FINE-CRS SAND, SOME SILT, LITTLE GRAVEL					18.0
20	7	13-20-25	20.0'-21.5'							
25	8	27-23-17	25.0'-26.5'		BOTTOM OF BORING @ 26.5'					26.5
					2" DIA WELL @ 25.0'					
					10.0' SCREEN					
					14.5' RISER					
					SAND FROM 26.5' TO 20.0'					
					BACKFILLED FROM 20.0' TO 14.0'					
35										
LEGEND: COL. A:							DRILLER: T. CZMYR			
SAMPLE TYPE: D=DRY A=AUGER C=CORE U=UNDISTURBED PISTON S=SPLIT SPOON							INSPECTOR:			
PROPORTIONS USED: TRACE=0-10% LITTLE=10-20% SOME=20-35% AND=35-50%							SHEET 1 OF 2 HOLE NO. MW-1			

CLARENCE WELTI ASSOC., INC. P.O. BOX 397 GLASTONBURY, CONN 06033				CLIENT		PROJECT NAME PROPOSED EXPANSION OF POND AT OWEN BELL PARK				
TOWN OF KILLINGLY						550 HARTFORD PKE. KILLINGLY, CT				
TYPE		AUGER	CASING	SAMPLER	CORE BAR.	OFFSET	SURFACE ELEV.		HOLE NO.	MW-3
SIZE I.D.		3.75"		1.375"		LINE & STA.	GROUND WATER OBSERVATIONS		START DATE	4/14/21
HAMMER WT.				140lbs		N. COORDINATE	AT 4.0 FT. AFTER 0 HOURS		FINISH DATE	4/14/21
HAMMER FALL				30"		E. COORDINATE	AT FT. AFTER HOURS			
DEPTH		SAMPLE			A	STRATUM DESCRIPTION + REMARKS				ELEV.
0		1	2-3-15-13	0.0'-2.0'		TOPSOIL				1.0
						BR.FINE-CRS.SAND, LITTLE SILT & GRAVEL - FILL				2.0
		2	4-3-2-3	2.0'-4.0'		TOPSOIL - FILL				4.0
						GREY/BR.SILT AND FINE SAND				9.0
5						GREY FINE-CRS.SAND, LITTLE GRAVEL, TRACE SILT				16.0
10		4	11-7-9	10.0'-11.5'		GREY FINE-MED.SAND, SOME SILT, TRACE GRAVEL				22.0
15		5	5-8-17	15.0'-16.5'		BOTTOM OF BORING @ 22.0' (AUEGR REFUSAL)				
						2" DIA.WELL @ 21.5'				
						10.0' SCREEN				
						11.0 RISER				
						SAND FROM 22.0' TO 9.0'				
						BENTONITE SEAL FROM 9.0' TO 7.0'				
20		6	4-6-60	20.0'-21.5'		BACKFILLED FROM 7.0' TO SURFACE				
		7	60	22.0'-22.1'						
25										
30										
35										
LEGEND: COL. A:						DRILLER: T. CZMYR				
SAMPLE TYPE: D=DRY A=AUGER C=CORE U=UNDISTURBED PISTON S=SPLIT SPOON						INSPECTOR:				
PROPORTIONS USED: TRACE=0-10% LITTLE=10-20% SOME=20-35% AND=35-50%						SHEET 1 OF 1		HOLE NO. MW-3		

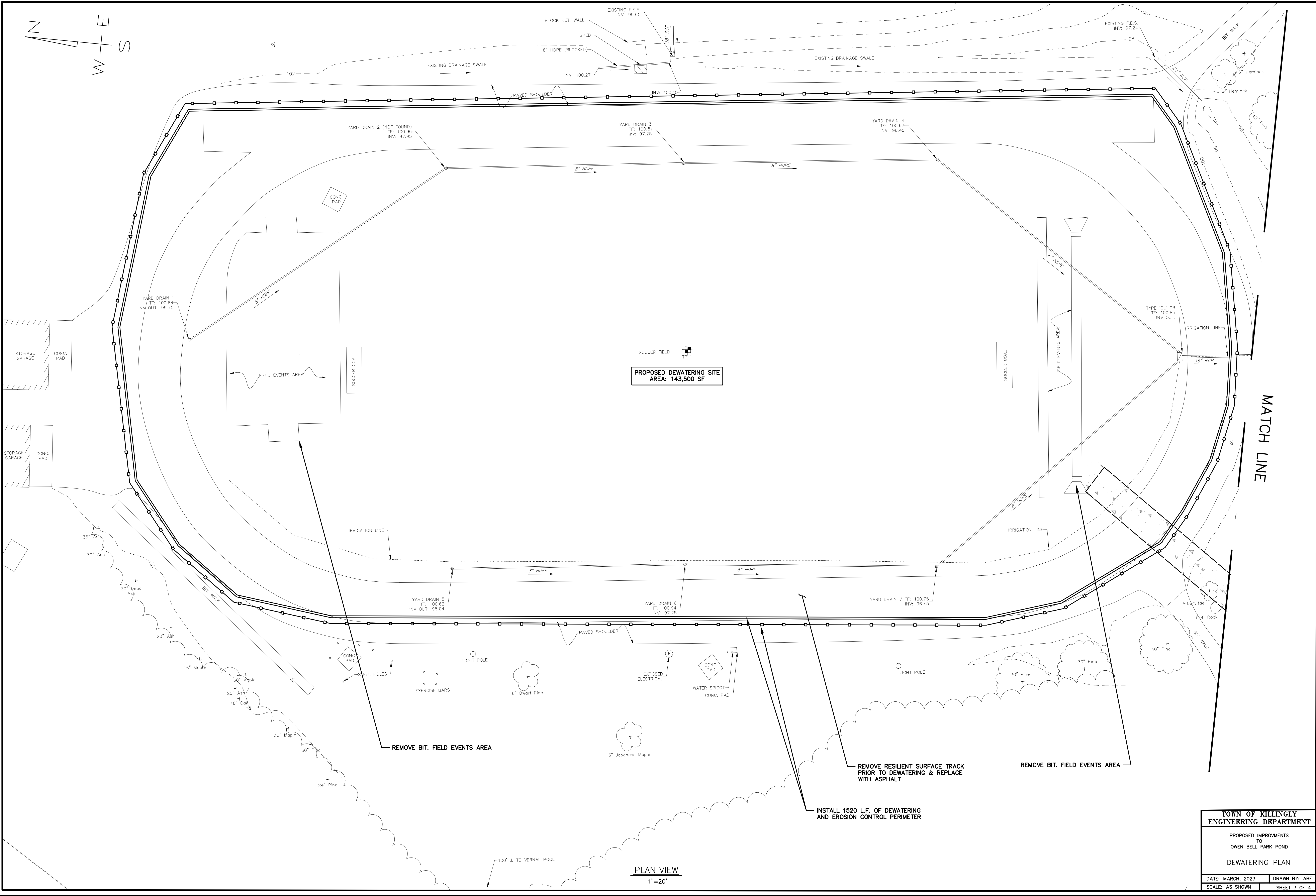

PLAN VIEW
1"=20'

TOWN OF KILLINGLY ENGINEERING DEPARTMENT	
PROPOSED IMPROVEMENTS TO OWEN BELL PARK POND	
DEWATERING PLAN	
DATE: MARCH, 2023	DRAWN BY: ABE
SCALE: AS SHOWN	SHEET 3 OF 4

MATCH LINE

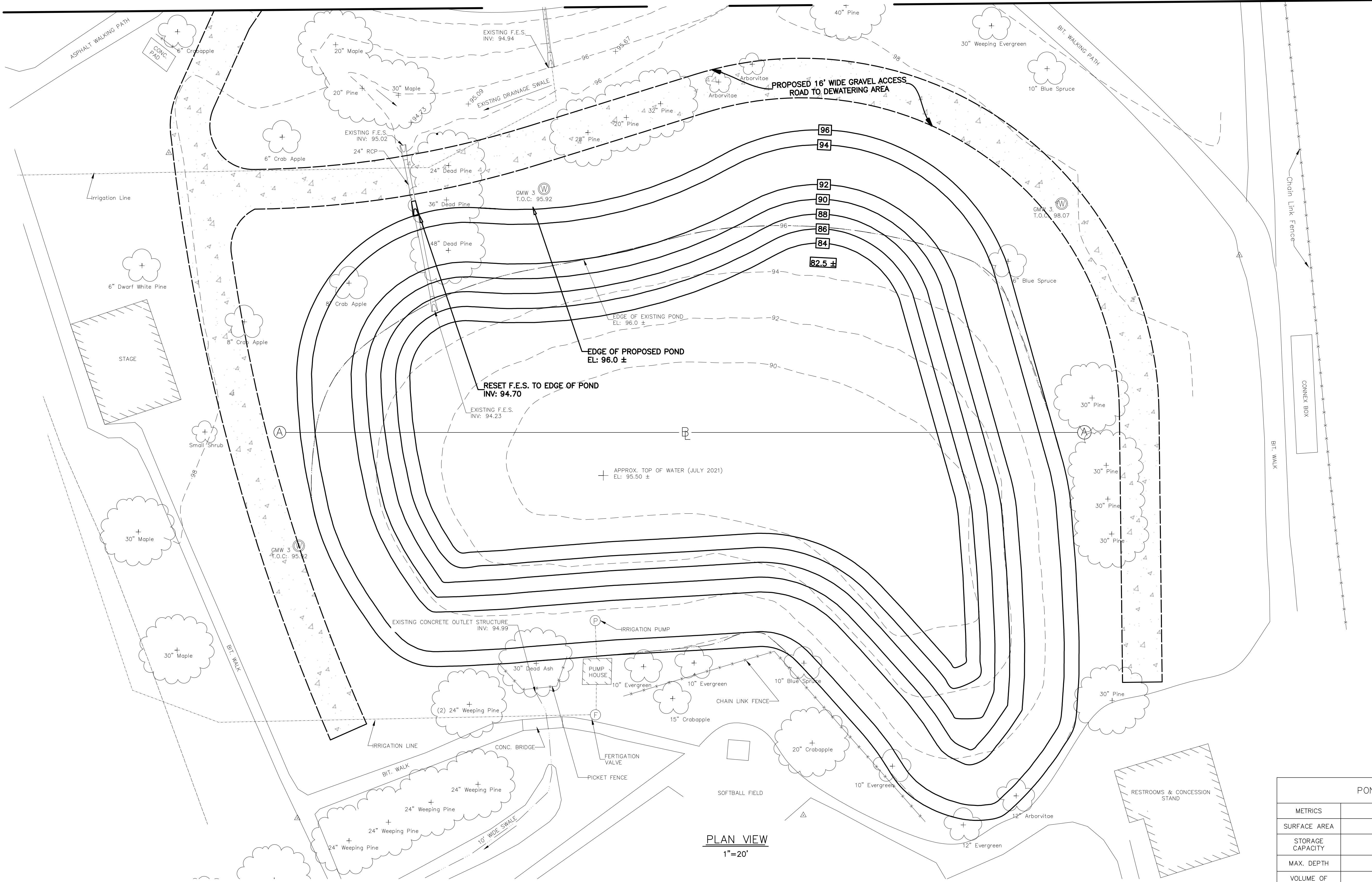
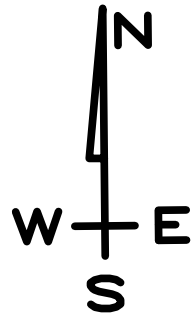

PLAN VIEW
1"=20'

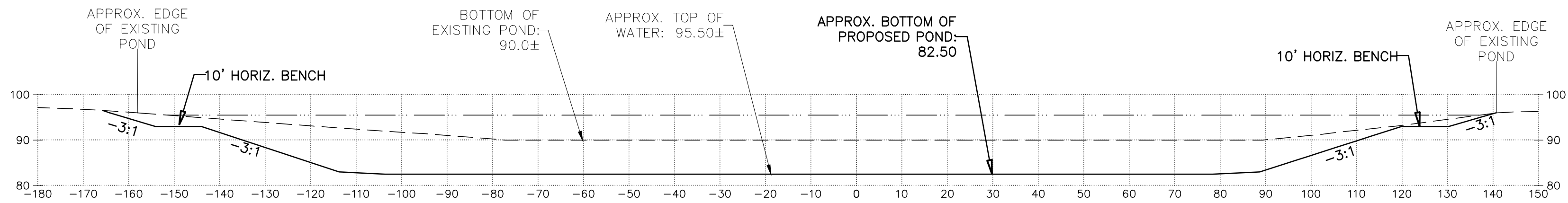

SECTION A-A
H: 1"=20'
V: 1"=20'

POND COMPARISON TABLE		
METRICS	EXISTING POND	PROPOSED POND
SURFACE AREA	51,237.62 FT ²	60,742.91 FT ²
STORAGE CAPACITY	1,300,454, GAL	3,663,305.40 GAL
MAX. DEPTH	± 4.5 FT	± 13 FT
VOLUME OF MATERIAL TO BE REMOVED	—	11,756.81 YD ³