

1556

NPS Form 10-900
(Rev. 8-86)

United States Department of the Interior
National Park Service

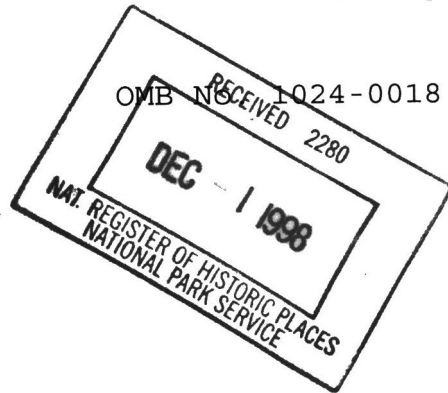

NATIONAL REGISTER OF HISTORIC PLACES REGISTRATION FORM

=====

1. Name of Property

historic name: BROAD STREET-DAVIS PARK HISTORIC DISTRICT

other name/site number: N/A

=====

2. Location

street & number: Academy, Broad, Cottage, Main, and Reynolds Streets -
see Item 7

city/town: Killingly not for publication: N/A
vicinity: Danielson

state: CT county: Windham code: 015 zip code: 06239

=====

3. Classification

Ownership of Property: private, public-local

Category of Property: district

Number of Resources within Property:

Contributing	Noncontributing	
<u>95</u>	<u>26</u>	buildings
<u>1</u>	<u>0</u>	sites
<u>0</u>	<u>0</u>	structures
<u>4</u>	<u>1</u>	objects
<u>100</u>	<u>27</u>	Total

Number of contributing resources previously listed in the National Register: 1

Name of related multiple property listing: N/A

4. State/Federal Agency Certification

As the designated authority under the National Historic Preservation Act of 1966, as amended, I hereby certify that this X nomination request for determination of eligibility meets the documentation standards for registering properties in the National Register of Historic Places and meets the procedural and professional requirements set forth in 36 CFR Part 60. In my opinion, the property X meets ___ does not meet the National Register Criteria. ___ See cont. sheet.

John W. Shannahan 11/19/98
Signature of certifying official Date
John W. Shannahan, Director, Connecticut Historical Commission

State or Federal agency and bureau

In my opinion, the property ___ meets ___ does not meet the National Register criteria. ___ See continuation sheet.

Signature of commenting or other official Date

State or Federal agency and bureau

5. National Park Service Certification

I, hereby certify that this property is:

- entered in the National Register ___ See continuation sheet.
- determined eligible for the National Register ___ See continuation sheet.
- determined not eligible for the National Register
- removed from the National Register
- other (explain):

Edison H. Beall 12/31/98

Beall Signature of Keeper Date of Action

6. Function or Use

Historic: DOMESTIC	Sub: single dwelling
DOMESTIC	multiple dwelling
RELIGION	religious facility
LANDSCAPE	park
Current: DOMESTIC	Sub: single dwelling
DOMESTIC	multiple dwelling
RELIGION	religious facility
LANDSCAPE	park

=====
7. Description
=====

Architectural Classification:

Stick/Eastlake
Queen Anne
Colonial Revival

Other Description: N/A

Materials: foundation STONE roof ASPHALT
walls WOOD other BRICK
BRICK

Describe present and historic physical appearance. X See continuation sheet.

=====
8. Statement of Significance
=====

Certifying official has considered the significance of this property in relation to other properties: state.

Applicable National Register Criteria: A,C

Criteria Considerations (Exceptions) : N/A

Areas of Significance: ARCHITECTURE
SOCIAL HISTORY

Period(s) of Significance: c.1860-1930

Significant Dates: See item 7

Significant Person(s): _____

Cultural Affiliation: _____

Architect/Builder: See Item 7

State significance of property, and justify criteria, criteria considerations, and areas and periods of significance noted above.
X See continuation sheet.

United States Department of the Interior
 National Park Service

**NATIONAL REGISTER OF HISTORIC PLACES
 CONTINUATION SHEET**

Description Broad Street-Davis Park Historic District 7-4
 Killingly, Windham County, CT

INVENTORY OF RESOURCES

ADDRESS	STORIES	DATE	DESCRIPTION	MATERIAL	C	NC
BUILDINGS						
52 Academy Street ABIEL CONVERSE HOUSE	1 1/2	1847	Greek Revival	clapboard	2	0
60 Academy Street JAMES E. BURGESS HOUSE	1 1/2	1847	Greek Revival	siding	1	0
63 Academy Street SAMUEL S. SPRAGUE HOUSE - Photograph 1	2 1/2	1851	Greek Revival/ Italianate	clapboard, shingle	2	0
66 Academy Street MATHILDA CUTTING HOUSE - Photograph 2	2 1/2	1856	Greek Revival	clapboard	1	0
69 Academy Street	1 1/2	c.1895	No style	clapboard	1	0
72-76 Academy Street GEORGE TRUESDELL TENEMENT	2 1/2	c.1865	No style	clapboard	1	0
95 Broad Street	2 1/2	c.1910	Queen Anne	clapboard, shingle	1	1
100 Broad Street	1 1/2	c.1960	No style	shingle	0	1
101 Broad Street	2 1/2	c.1910	Queen Anne	clapboard, shingle	1	0
104 Broad Street	2 1/2	1912	Queen Anne	siding, shingle	1	1
107 Broad Street	2 1/2	c.1916	No style	siding	1	1
110 Broad Street Photograph 3	2	c.1925	Colonial Revival	clapboard	1	1
111 Broad Street	1 1/2	c.1960	No style	brick, shingle	0	2
114 Broad Street	1 1/2	c.1900	Victorian	clapboard	2	0
117 Broad Street	2	c.1960	No style	siding	0	1
120 Broad Street SECOND HEZEKIAH DANIELSON HOUSE - Photograph 4	1 1/2	c.1835	Cape style	clapboard	1	1
123 Broad Street	2 1/2	c.1905	Victorian	siding	1	0

United States Department of the Interior
National Park Service

NATIONAL REGISTER OF HISTORIC PLACES CONTINUATION SHEET

Description Broad Street-Davis Park Historic District 7-5
Killingly, Windham County, CT

INVENTORY OF RESOURCES

ADDRESS	STORIES	DATE	DESCRIPTION	MATERIAL	C	NC
126 Broad Street Photograph 5	2 1/2	c.1895	Victorian	clapboard, shingle	2	0
129 Broad Street	2 1/2	c.1925	Foursquare	clapboard, shingle	1	1
130 Broad Street Photograph 5	1 1/2	c.1927	Bungalow	shingle	2	0
135 Broad Street FREDERICK BITGOOD HOUSE	2 1/2	1903	Queen Anne	siding	1	1
136 Broad Street Photograph 5	1 1/2	c.1930	Bungalow	shingle	1	1
141 Broad Street	2 1/2	1920	Colonial Revival	siding	2	0
147 Broad Street CHARLES F. COON HOUSE	1 1/2	c.1874	No style	clapboard	1	1
150 Broad Street EDWIN L. PALMER HOUSE - Photograph 6	2 1/2	c.1895	Colonial Revival	clapboard	1	0
151 Broad Street CHARLES & ELIZABETH CUNDALL HOUSE	1 1/2	c.1885	Victorian	siding	1	0
158 Broad Street	1	c.1980	No style	shingle	0	1
162 Broad Street FREDERICK A. JACOBS HOUSE - Photograph 7	2	c.1890	Queen Anne	clapboard, shingle	2	0
170 Broad Street	2 1/2	c.1950	No style	brick	0	2
176 Broad Street	2 1/2	c.1950	No style	shingle	0	2
182 Broad Street FIRST HEZEKIAH DANIELSON HOUSE	2 1/2	c.1825	Federal	siding	2	0
185 Broad Street OLD KILLINGLY HIGH SCHOOL	2	1903, 1920	Renaissance Revival	brick	1	0
194-98 Broad Street GEORGE CLARK HOUSE	2 1/2	1883	Queen Anne	clapboard	2	0
201 Broad Street	2 1/2	c.1885	Victorian	clapboard, shingle	1	0
204 Broad Street FRANK T. PRESTON HOUSE - Photograph 8	2 1/2	c.1890	Stick/Eastlake	clapboard, shingle	1	1

United States Department of the Interior
National Park Service

**NATIONAL REGISTER OF HISTORIC PLACES
CONTINUATION SHEET**

Description Broad Street-Davis Park Historic District 7-6
 Killingly, Windham County, CT

INVENTORY OF RESOURCES

ADDRESS	STORIES	DATE	DESCRIPTION	MATERIAL	C	NC
209 Broad Street LAURA DAVIS HOUSE	2 1/2	c.1890	Victorian	clapboard	1	0
212 Broad Street JOHN A. PAINE HOUSE - J. H. Daverman & Son, architect - Photograph 9	2 1/2	c.1894	Gothic Revival	clapboard, shingle	2	0
213 Broad Street GEORGE H. CALL HOUSE	2 1/2	c.1898	Stick/Eastlake	siding	2	0
219 Broad Street EDMUND L. WARREN HOUSE	2 1/2	c.1890	Italianate	clapboard	1	0
222 Broad Street CHARLES B. WHEATLEY HOUSE - Photograph 9	2 1/2	1893	Queen Anne	clapboard, shingle	1	0
223 Broad Street ASAHEL G. SCRANTON HOUSE	2 1/2	c.1892	Victorian	clapboard, shingle	1	0
231 Broad Street HARRIET POTTER HOUSE	2 1/2	c.1890	Queen Anne	clapboard	1	0
232 Broad Street ERASTUS W. SCOTT HOUSE - Photograph 10	2 1/2	c.1885	Queen Anne	clapboard, shingle	2	0
239 Broad Street BAPTIST CHURCH PARSONAGE	2	1894	Stick/Eastlake	siding	2	0
246 Broad Street CHARLES S. HAWKINS HOUSE	2 1/2	1873	Italianate	clapboard	3	0
247 Broad Street BAPTIST CHURCH OF DANIELSON - PHOTOGRAPH 18	2	1966	Contemporary	siding	0	1
254 Broad Street ST. ALBAN'S EPISCOPAL CHURCH, RECTORY & HALL - Stephen C. Earle, architect - Photograph 17	1 1/2	1891	Gothic Revival	brick,	3	0
259 Broad Street	2 1/2	c.1910	No style	clapboard, shingle	1	0
262 Broad Street WILLIAM C. AND MARY BACON HOUSE	2	c.1851	Greek Revival/ Victorian additions	clapboard	2	0
264 Broad Street ENO AND HANNAH ROBERTS HOUSE	1 1/2	c.1891	Victorian	clapboard	1	0
270 Broad Street Photograph 11	1 1/2	c.1860	Italianate	clapboard	1	0
276 Broad Street	2 1/2	c.1881	Gothic Revival	siding	2	0

United States Department of the Interior
National Park Service

**NATIONAL REGISTER OF HISTORIC PLACES
CONTINUATION SHEET**

Description Broad Street-Davis Park Historic District 7-7
Killingly, Windham County, CT

INVENTORY OF RESOURCES

ADDRESS	STORIES	DATE	DESCRIPTION	MATERIAL	C	NC
RICHARD S. LATHROP HOUSE - Photograph 12						
294 Broad Street JONATHAN DEXTER HOUSE	2 1/2	c.1862	Greek Revival	clapboard	2	0
302 Broad Street GEORGE D. BATES HOUSE	1 1/2	c.1865	Victorian	clapboard	1	0
308 Broad Street WILLIAM H. CHOLLAR HOUSE	2 1/2	c.1871	Italianate	clapboard	2	0
314 Broad Street WILLIAM T. SPAULDING HOUSE	2 1/2	c.1872	No style	clapboard	2	0
101 Cottage Street (corner of Broad Street)	2 1/2	c.1915	Colonial Revival	clapboard	1	0
117 Cottage Street (in triangle with Broad Street) - former METHODIST PARSONAGE	2 1/2	c.1890	No style	siding	1	0
227 Main Street THOMAS DEXTER HOUSE	2 1/2	c.1865	No style	siding	1	0
231 Main Street HARRIET N. HYDE HOUSE	2 1/2	c.1875	Italianate	siding	1	0
235 Main Street	2 1/2	c.1880	Italianate	siding	1	1
239 Main Street	2	c.1860	No style	siding	1	1
245 Main Street	2	c.1900	No style	siding	1	0
255 Main Street JOHN AND HULDAH DAVIS HOUSE	1 1/2	c.1845	Greek Revival	siding	2	0
267 Main Street ORVIL M. CAPRON HOUSE - Photograph 13	2	c.1855	Italianate	clapboard	1	1
275 Main Street EDWARD H. JACOBS HOUSE	2 1/2	c.1890	Victorian	shingle	1	0
281 Main Street WILLIAM AND ELIZA COMINS HOUSE	2 1/2	c.1870	Italianate	clapboard	1	0
285 Main Street HIRAM TANNER HOUSE	2 1/2	c.1870	Italianate	clapboard	2	0
301 Main Street RIENZI ROBINSON HOUSE	2 1/2	c.1885	Victorian	clapboard	2	0

United States Department of the Interior
National Park Service

**NATIONAL REGISTER OF HISTORIC PLACES
CONTINUATION SHEET**

Description Broad Street-Davis Park Historic District 7-8
Killingly, Windham County, CT

INVENTORY OF RESOURCES

ADDRESS	STORIES	DATE	DESCRIPTION	MATERIAL	C	NC
307 Main Street Photograph 14	2 1/2	c.1910	No style	clapboard, shingle	1	0
315 Main Street Photograph 14	1 1/2	c.1925	Bungalow	shingle	1	0
19 Reynolds Street	2 1/2	1895	Colonial Revival	clapboard	2	0
25 Reynolds Street	2 1/2		No style	clapboard	0	2
33 Reynolds Street GEORGE J. CLARK HOUSE (Gagnon-Costello Funeral Home) - Photograph 15	2 1/2	c.1870	Second Empire	brick	1	0
42 Reynolds Street (corner of Broad Street) - Allard's Pharmacy	1	c.1985	No style	brick	0	1
6 Spring Street (corner of Main Street) J.Q.A. STONE HOUSE	2 1/2	1868	Italianate	clapboard	1	0
- Bounded by Broad, Main and Reynolds RANDALL AND PHILIA DAVIS MEMORIAL PARK BANDSTAND - Photograph 21		1890	Victorian-style	bandstand	1	0

OBJECTS

- Davis Park SOLDIERS AND SAILORS MONUMENT - Photograph 20		1878	Statue and cannon		2	0
- Davis Park WORLD WAR I MONUMENT - Photograph 19		1933	Granite monument		1	0
- Davis Park WORLD WAR II MONUMENT		c.1950	Granite monument		1	0
- Davis Park DESERT STORM MONUMENT		c.1992	Granite monument		0	1

SITES

- Bounded by Broad, Main and Reynolds RANDALL AND PHILIA DAVIS MEMORIAL PARK - Photograph 19		1890	Park, bandstand		1	0
---	--	------	-----------------	--	---	---

United States Department of the Interior
National Park Service

NATIONAL REGISTER OF HISTORIC PLACES CONTINUATION SHEET

Significance	Broad Street-Davis Park Historic District Killingly, Windham County, CT	8-1
--------------	--	-----

Summary

The Danielson Broad Street-Davis Park Historic District is significant for the architectural qualities of its buildings, many of which are richly detailed and well-preserved examples of Victorian architecture (Criterion C) and for its historical associations with institutions and people important in the development of Danielson (Criterion A). The large ornate houses along Broad Street are typical of the domestic architecture favored in the Victorian period by local elites throughout America; in the case of Danielson, they were originally built by the merchants and industrialists who benefited from Danielson's prosperity in the late 19th and early 20th centuries. Although chiefly known for its textile manufacturing, Danielson in that period was also a commercial center for nearby outlying communities. Davis Park itself is a symbol of Danielson's coming of age in the 1890s; with its bandstand, war monuments, benches, and shade trees, it provided a place of respite, celebration, and remembrance for the growing borough.

Historic Context

In the late 18th and early 19th centuries most of what is now Danielson was simply an outlying agricultural area within the Town of Killingly. The eastern end of present-day Danielson was known as Westfield, and the only major highway in the area was Broad Street, a colonial stage road that was later improved as a turnpike.

In 1809 local landowners James and Hezekiah Danielson joined with some Rhode Island entrepreneurs to start the Danielson Manufacturing Company, which erected one of eastern Connecticut's earliest textile factories, a cotton spinning mill. Located on the Five-Mile River near its confluence with the Quinebaug River, the Danielson mill took advantage of the area's abundant waterpower. It was soon joined by other mills, including that built by Comfort and Ebenezer Tiffany, on the western side of the Quinebaug within the town of Brooklyn. The town's economic vigor was furthered in 1830, when the Norwich and Worcester Railroad was completed through Killingly. The location of the railroad station, as well as the several mills at the juncture of the two rivers, began to orient the settlement westward, away from Westfield. Hotels and restaurants were built up around the station, then known as "Depot Village," to serve the needs of travelers, and several large business blocks appeared along Main Street in response to a growing commercial sector. In 1848 Danielson began publishing its first newspaper, *The Windham County Telegraph*, later succeeded by the

United States Department of the Interior
National Park Service

NATIONAL REGISTER OF HISTORIC PLACES CONTINUATION SHEET

Significance

Broad Street-Davis Park Historic District
Killingly, Windham County, CT

8-4

company store. People who made their fortunes from non-textile enterprises also lived in the neighborhood: real estate/investment agent Edwin L. Palmer (150 Broad Street, Photograph 6), jeweler Frank T. Preston (204 Broad Street, Photograph 8), storekeepers Charles B. Wheatley and Frederick E. Bitgood (222 and 135 Broad Street, Photograph 9), lumber and coal dealer John A. Paine (312 Broad Street, Photograph 9), and buggy whip-socket maker Erastus Scott (Broad Street, Photograph 10). Long-time *Windham County Transcript* editor J. Q. A. Stone lived in a house in the district (4 Spring Street), as did physician Rienzi Robinson (301 Main Street) and attorney and Probate Judge James H. Potter (231 Broad Street).

Davis Park, created in 1890, added an important amenity that benefitted not only the immediate neighborhood but also the entire town. It was named in honor of Randall and Philia Kies Davis, the parents of Edwin Davis, who donated the major part of the land in 1889. Like so many other small-town philanthropists, Davis had left his boyhood home to make his fortune elsewhere, leaving Danielson and eventually settling in Iowa. Bandstands are not commonly found in New England village parks; the Davis Park bandstand, which early views show to be original, may reflect Edwin Davis's exposure to Midwestern town squares.

Architectural Significance

The Broad Street-Davis Park Historic District has architectural significance because it is an exceptional concentration of richly detailed, well-preserved Victorian buildings. A number of the houses rank among the most elaborate examples of their respective styles in eastern Connecticut, such as the c.1855 Italianate-style Orvil M. Capron house (Photograph 13), an early example of the Italian Villa mode; the rambling Queen Anne-style Erastus Scott House (Photograph 10), built about 1885; and the c.1895 Colonial Revival-style Edwin L. Palmer House (Photograph 6). However, the architectural significance of the district goes beyond the individual houses; taken as a whole, the district illustrates the wide variety in historical stylistic precedents, materials, plans, ornamental details, and degree of elaboration that characterized Victorian and early 20th-century architecture.

The number of unique architectural styles in the district reflect the eclecticism that characterized the late 19th and early 20th centuries, when architects and builders ranged far and wide in their search for inspiration. In addition to Greek Revival-style holdovers from an

=====
9. Major Bibliographical References
=====

X See continuation sheet.

Previous documentation on file (NPS):

- preliminary determination of individual listing (36 CFR 67) has been requested. Old Killingly High School, 185 Broad Street
X previously listed in the National Register
- previously determined eligible by the National Register
- designated a National Historic Landmark

- recorded by Historic American Buildings Survey # _____
- recorded by Historic American Engineering Record # _____

Primary Location of Additional Data:

- X State historic preservation office Connecticut Historical Commission
- Other state agency 59 South Prospect Street
- Federal agency Hartford, Connecticut 06106
- Local government
- University
- Other -- Specify Repository: _____

=====
10. Geographical Data
=====

Acreage of Property: approx. 30 acres

UTM References: Zone Easting Northing Zone Easting Northing
A ___ ___ B ___ ___
C ___ ___ D ___ ___

X See continuation sheet.

Verbal Boundary Description: ___ See continuation sheet.
The boundary is shown on the accompanying map, scale 1"=200'.

Boundary Justification: X See continuation sheet.

=====
11. Form Prepared By
=====

Name/Title: Bruce Clouette and Hoang Tinh, reviewed by John Herzan,
Conn. Hist. Commission
Organization: Historic Resource Consultants Date: September 15, 1997
Street & Number: 55 Van Dyke Avenue Telephone: 860-547-0268
City or Town: Hartford State: CT Zip: 06106

United States Department of the Interior
National Park Service

**NATIONAL REGISTER OF HISTORIC PLACES
CONTINUATION SHEET**

Geographic Data Broad Street-Davis Park Historic District 10-1
 Killingly, Windham County, CT

BOUNDARY JUSTIFICATION:

The historic district was drawn so as to include the large predominantly Victorian-style houses on Broad Street, distinctive for their size and architectural elaboration and for their associations with Danielson's merchant-industrialist upper middle class. Davis Park defines one end of Broad Street; the houses on the opposite side of the park were included because many are of the same type as those along Broad Street. The side streets leading off Broad Street are not included; although the houses are generally of the same age as those on Broad Street, nearly all of them are smaller and more plainly detailed and thus do not accord with the architectural and historical themes evident in the district as drawn. The exceptions are Reynolds Street and Academy Street, both of which have at least one building that fits the theme. Reynolds Street also faces the park. Finally, both Reynolds Street and Academy Street (the latter a local historic District) are short streets lying between the National Register-listed Danielson Main Street Historic District and the district described in this nomination.

UTM REFERENCES:

- 1: 19.260780.4632420
- 2: 19.260820.4632380
- 3: 19.260770.4632340
- 4: 19.260800.4632300
- 5: 19.260780.4632190
- 6: 19.260740.4632200
- 7: 19.260740.4632160
- 8: 19.260770.4632150
- 9: 19.260740.4631770
- 10: 19.260700.4631450
- 11: 19.260620.4631450
- 12: 19.260660.4631720
- 13: 19.260640.4631750
- 14: 19.260660.4631620
- 15: 19.260690.4632020
- 16: 19.260650.4632020
- 17: 19.260640.4632060
- 18: 19.260630.4632140
- 19: 19.260600.4632150
- 20: 19.260550.4632180

United States Department of the Interior
National Park Service

NATIONAL REGISTER OF HISTORIC PLACES
CONTINUATION SHEET

Photographs Broad Street-Davis Park Historic District Photos-1
 Killingly, Windham County, CT

All photographs:

1. Broad Street-Davis Park Historic District
2. Killingly, Windham County, CT
4. September, 1997 and October, 1998
5. Negative filed with Connecticut Historical Commission
 Hartford, CT

Captions:

Samuel S. Sprague House, 63 Academy Street, camera facing southwest
Photograph 1 of 21

Mathilda Cutting House, 66 Academy Street, left, George Truesdell
Tenement, 72-76 Academy Street, right, camera facing northwest
Photograph 2 of 21

Colonial Revival style house, 110 Broad Street, camera facing southeast
Photograph 3 of 21

Hezekiah Danielson House, 120 Broad Street, camera facing southeast
Photograph 4 of 21

Bungalow-style house, 130 Broad Street, and Victorian-vernacular style
house, 126 Broad Street, right, camera facing northeast
Photograph 5 of 21

Edwin L. Palmer House, 150 Broad Street, camera facing northeast
Photograph 6 of 21

Frederick A. Jacobs House, 162 Broad Street, camera facing southeast
Photograph 7 of 21



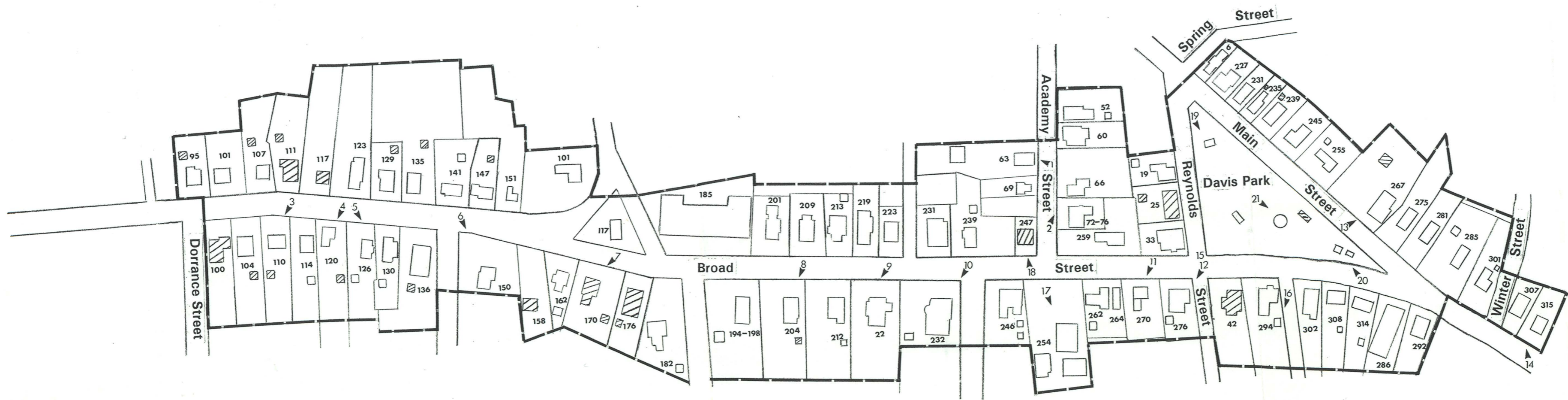

Frank T. Preston House, 204 Broad Street, camera facing southeast
Photograph 8 of 21

Charles B. Wheatley House, 222 Broad Street, left, John A. Paine House,
212 Broad Street, right, camera facing southeast
Photograph 9 of 21



**Danielson Broad Street - Davis Park
Historic District**

Killingly, Windham County, CT

-  District Boundary
-  Photo Positions
-  Contributing
-  Noncontributing



UNITED STATES DEPARTMENT OF THE INTERIOR
NATIONAL PARK SERVICE

NATIONAL REGISTER OF HISTORIC PLACES
EVALUATION/RETURN SHEET

REQUESTED ACTION: NOMINATION

PROPERTY NAME: Broad Street--Davis Park Historic District

MULTIPLE NAME:

STATE & COUNTY: CONNECTICUT, Windham

DATE RECEIVED: 12/01/98 DATE OF PENDING LIST: 12/15/98
DATE OF 16TH DAY: 12/31/98 DATE OF 45TH DAY: 1/15/99
DATE OF WEEKLY LIST:

REFERENCE NUMBER: 98001556

NOMINATOR: STATE

REASONS FOR REVIEW:

APPEAL: N DATA PROBLEM: N LANDSCAPE: N LESS THAN 50 YEARS: N
OTHER: N PDIL: N PERIOD: N PROGRAM UNAPPROVED: N
REQUEST: N SAMPLE: N SLR DRAFT: N NATIONAL: N

COMMENT WAIVER: N

ACCEPT RETURN REJECT 12/31/98 DATE

ABSTRACT/SUMMARY COMMENTS:

Entered in the National Register
Entered in the National Register

RECOM./CRITERIA _____

REVIEWER _____ DISCIPLINE _____

TELEPHONE _____ DATE _____

DOCUMENTATION see attached comments Y/N see attached SLR Y/N







Killingly
Chiropractic Center
Dr. Philip J. DiCaspero
100 Broad St.















NO THRU TRUCKS

HAWKINS ST





NO
THRU
TRUCKS

REYNOLDS

25

SLOW









SPEED
LIMIT
25

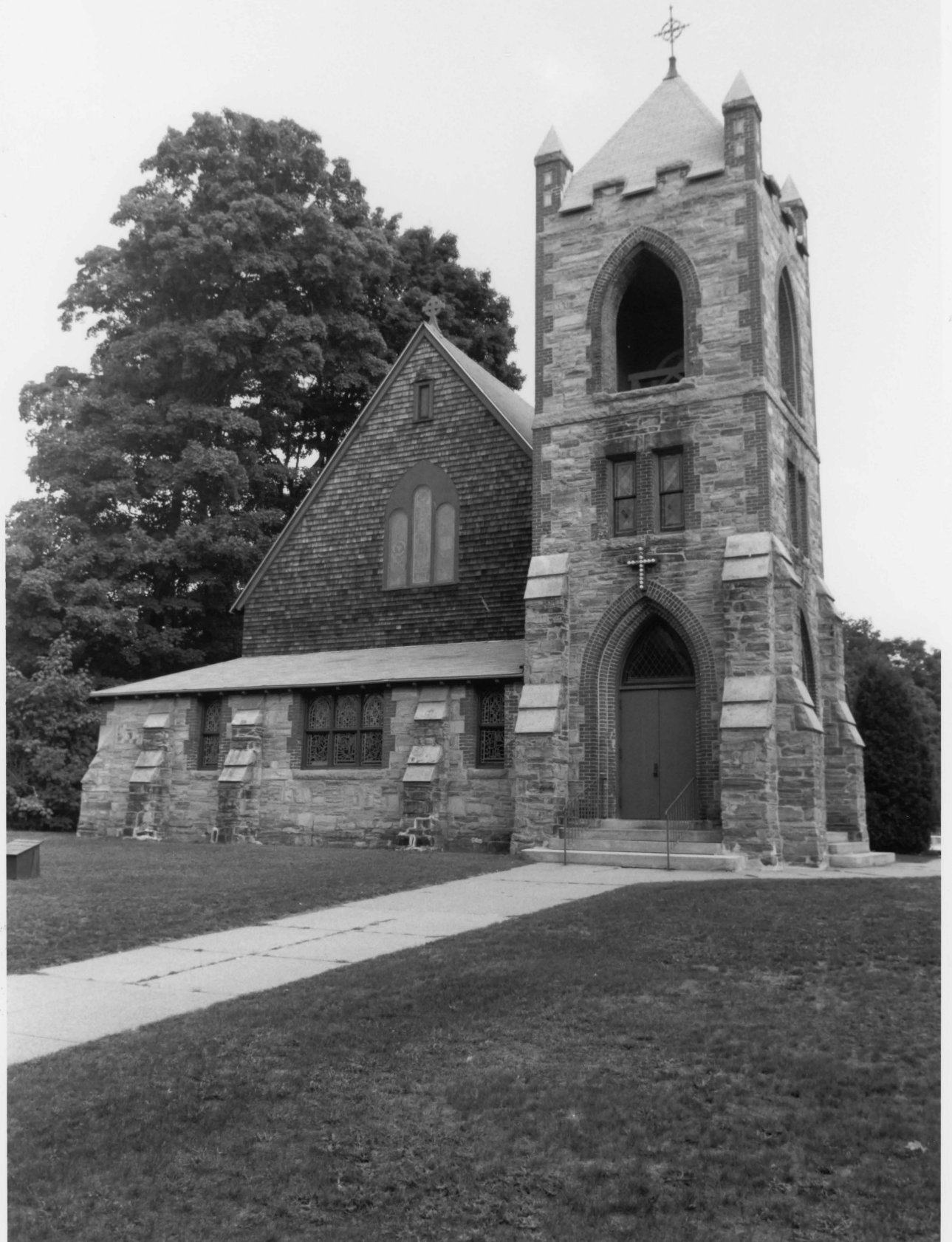







ERECTED A. D. 1876
BY THE WOMEN
OF THE TOWN OF KALAMAZOO
IN HONOR OF THE SOLDIERS AND OFFICERS
WHO SERVED IN THE WAR OF 1812





BROAD STREET - DAVIS
PARK HISTORIC DISTRICT
KILLINGLY,
WINDHAM COUNTY,
CONNECTICUT

- UTM REFERENCES:
(EAST KILLINGLY 57 MI. 6667 IV SE)
1: 19.260780.4632420
2: 19.260820.4632380
3: 19.260770.4632340
4: 19.260800.4632300
5: 19.260780.4632190
6: 19.260740.4632200
7: 19.260740.4632160
8: 19.260770.4632150
9: 19.260740.4631770
10: 19.260700.4631450
11: 19.260620.4631450
12: 19.260660.4631720
13: 19.260640.4631750
14: 19.260660.4631620
15: 19.260690.4632020
16: 19.260650.4632020
17: 19.260640.4632060
18: 19.260630.4632140
19: 19.260600.4632150
20: 19.260550.4632180

Mapped, edited, and published by the Geological Survey
Control by USGS, USCGS, and Connecticut Geodetic Survey
Topography by planetable surveys 1943. Revised 1955
Polyconic projection. 1927 North American datum
10,000-foot grid based on Connecticut coordinate system
1000-meter Universal Transverse Mercator grid ticks,
zone 19, shown in blue
Revisions shown in purple compiled in cooperation with
Connecticut Highway Department from aerial photographs
taken 1970. This information not field checked
To place on the predicted North American Datum 1983,
move the projection lines 6 meters south and
40 meters west as shown by dashed corner ticks

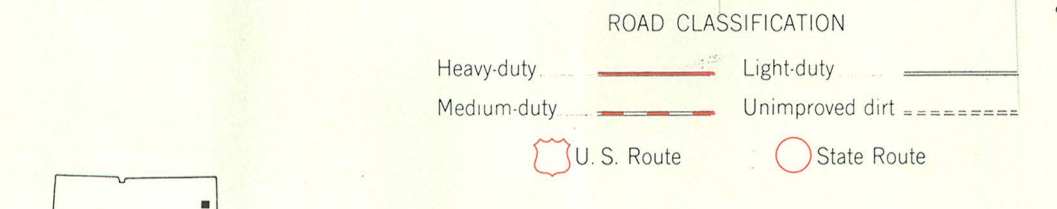
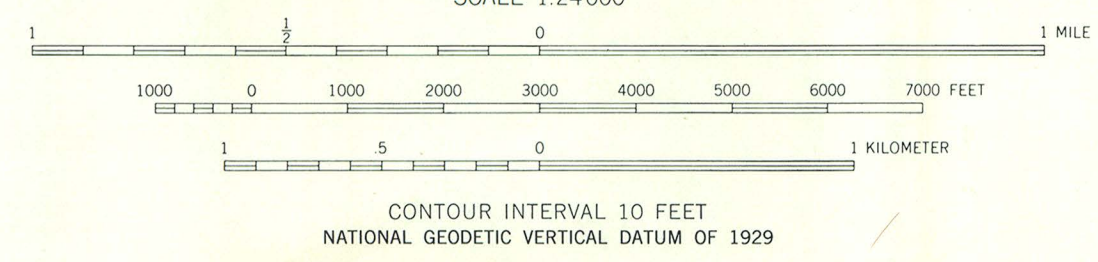
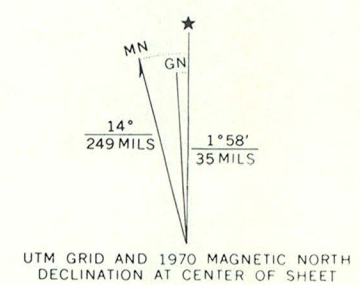

THIS MAP COMPLIES WITH NATIONAL MAP ACCURACY STANDARDS
FOR SALE BY U.S. GEOLOGICAL SURVEY, DENVER, COLORADO 80225, OR RESTON, VIRGINIA 22092
A FOLDER DESCRIBING TOPOGRAPHIC MAPS AND SYMBOLS IS AVAILABLE ON REQUEST

DANIELSON, CONN.
41071-G8-F024
1955
PHOTOREVISED 1970
DMA 6667 IV SW SERIES V816

TOWN OF KILLINGLY

**Town Manager's Office
Killingly Town Hall
172 Main St., P. O. Box 6000
Danielson, CT 06239
Phone (860)779-5334
Fax (860)779-5382**

Fax Cover Sheet

FAX #: 1-860-566-5078

DATE: October 14, 1998

TO: John Herzan

FROM: Marc Skocypec

RE: Broad Street-Davis Park Historic District

Number of pages including cover sheet: 3



Town of Killingly

TOWN HALL ♦ 172 MAIN STREET ♦ P.O. BOX 6000 ♦ DANIELSON, CONNECTICUT 06239-6000
TELEPHONE ♦ 860-779-5300 FAX ♦ 860-779-5394

October 14, 1998

Mr. John Herzan
CT Historical Commission
59 South Prospect St.
Hartford, CT 06106

Dear Mr. Herzan:

**RE: BROAD STREET-DAVIS PARK HISTORIC DISTRICT NOMINATION TO
THE NATIONAL REGISTER OF HISTORIC PLACES**

This letter is to inform you that the Killingly Historic District Commission has reviewed the above-referenced application. In addition, most members also attended the public hearing that was held on the proposed nomination.

Unfortunately, due to circumstances beyond our control, the Commission has been unable to meet for the last several months. While the conversations that I have had individually with the Commission members is supportive, they have been unable to meet to formalize any action on the proposed nomination.

I am confident that, within the next several weeks, we will be able to have a meeting and take formal action on the proposed nomination; however, it will be after your scheduled meeting on October 15, 1998.

I will keep you advised as to the progress we are making on this issue. Please contact me if you have any questions.

Sincerely,



Marc A. Skocypec
Assistant Town Manager

MAS/jc

Certified Local Government Program
Chief Elected Official's Comment Form
for Nominations to the
National Register of Historic Places

District/Property Name: BROAD STREET-DAVIS PARK HISTORIC DISTRICT

Address (for individual nomination): _____

Executive
As the Chief ~~EXECUTIVE~~ Official for Town of Killingly
(Name of Municipality)

I hereby

X approve

_____ do not approve

of the submission by the State Historic Preservation Officer of the National Register of Historic Places Registration Form for the district/property noted above to the National Park Service for review and listing of the resource on the National Register of Historic Places.

R. Thomas Homan _____ Title Town Manager

October 14, 1998
Date

PUBLIC INFORMATION MEETING

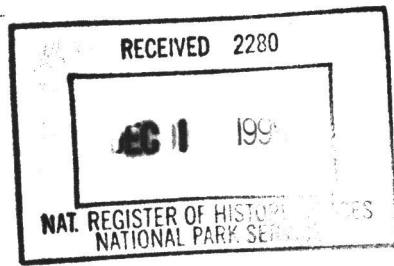

on the
proposed

RECEIVED
MAY 22 1998
Comm. Commission

BROAD STREET/DAVIS PARK HISTORIC DISTRICT

Wednesday, May 27, 1998

7:00 p.m.

**Killingly Public Library
Community Room
25 Westcott Road
Danielson**

**Co-sponsored by the
Killingly Historic District Commission
and the
Connecticut Historical Commission**

